

# CHAPMAN RANCH

(OSO CREEK NW, p.195)

[Click Here or Scroll Down for Associated Map Data](#)

Click on the Geographic Response Plan Target to View the ICS Form

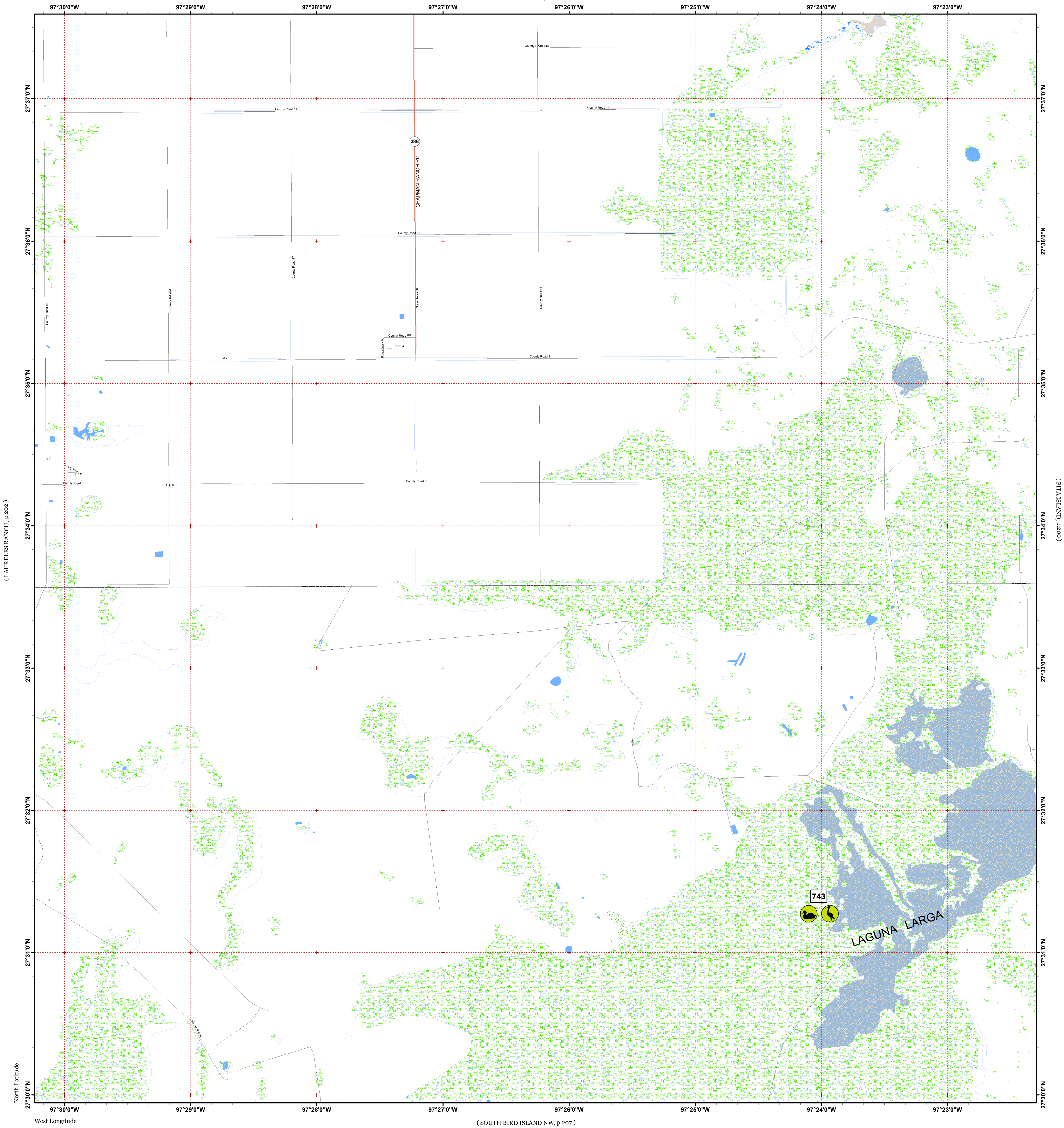

(LAURELES RANCH, p.202)

(CIN ISLAND, p.200)

(SOUTH BIRD ISLAND NW, p.207)



Oil Spill Planning and Response Atlas  
2016

The Texas General Land Office makes no representations or warranties regarding the accuracy or completeness of the information depicted on this map or the data from which it was produced. This map is not suitable for navigational purposes and does not purport to depict boundaries of private and public land.

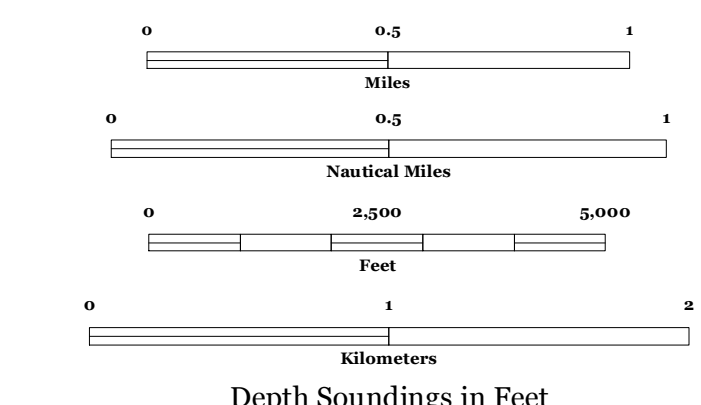
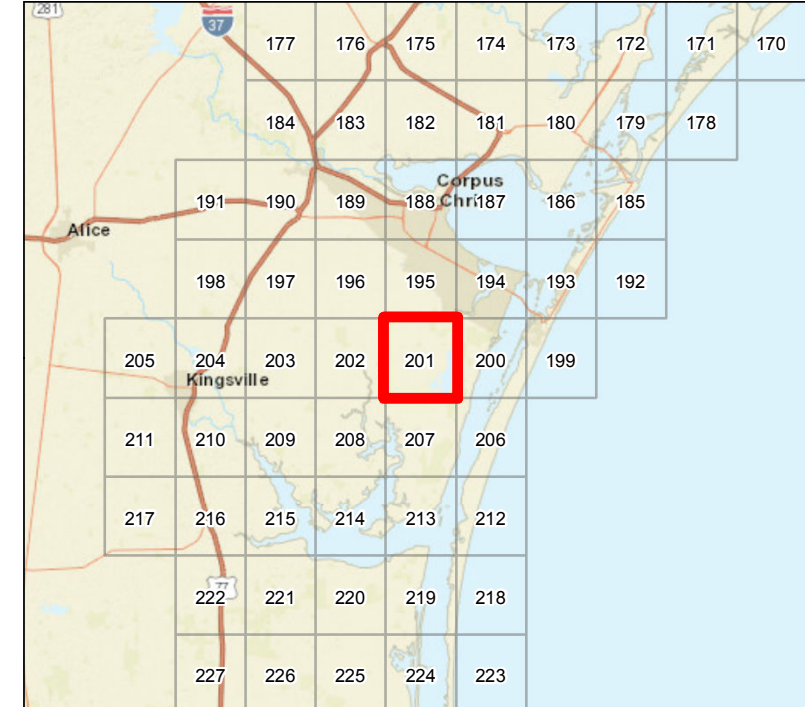

### Human Use Features

- State Highway
- Road
- Salt and Brackish Marshes
- Beach or Tidal Flat
- Exposed Lake Shore
- Freshwater Marshes
- Willow Thickets
- Lake / Pond
- County Boundary

### Map Base Layers

- State Highway
- Road
- Salt and Brackish Marshes
- Beach or Tidal Flat
- Exposed Lake Shore
- Freshwater Marshes
- Willow Thickets
- Lake / Pond
- County Boundary

### Species Icons Within Map Quad

- Wading
- Waterfowl

### Priority Protection Areas

### ENVIRONMENTAL SENSITIVITY INDEX

- 10D Mangroves and Woody Vegetation
- 10C Freshwater Swamps
- 10B Freshwater Marshes
- 10A Salt and Brackish Water Marshes
- 9 Sheltered Tidal Flats
- 8C Sheltered Rocky/Karst Shores
- 8D Sheltered Scarp
- 8B Sheltered Riprap Structures
- 8A Sheltered Solid Manmade Structures
- 7 Exposed Tidal Flats
- 6B Exposed Riprap Structures
- 6A Gravel or Shell Beaches
- 5 Mixed Sand and Gravel or Shell Beaches
- 4 Coarse-Grained Sand Beaches
- 3B Scarp and Steep Slopes in Sand
- 3A Fine-Grained Sand Beaches
- 2B Wave-Cut Clay Platforms
- 2A Scarp and Steep Slopes in Clay
- 1 Exposed Walls and Other Solid Structures

Quadrant: **CHAPMAN RANCH**

Map # :201

Biological Information for this quadrant represents known concentration areas of occurrence.

## Biological Resources

## Bird

RARNUM	NAME	S	F	CONC	J	F	M	A	M	J	J	A	S	O	N	D	NESTING	LAYING	HATCHING	FLEDGING
743	Sandhill crane				X	X	X	X					X	X	X	X				
	Waterfowl				X	X	X	X	X	X	X	X	X	X	X	X				
	Northern shoveler				X	X	X	X	X				X	X	X	X				
	Lesser scaup				X	X	X	X					X	X	X	X				